



LEDTEC

300W LCF HIGHBAY

TECHNICAL DATA SHEET

The LCF highbay combines reliability, efficiency, and robustness, making it the ideal LED replacement for most industry standard gas discharge lamp-based highbays of up to 400W for heights up to 8 metres. It comes packaged with hook and chain mounts to make the installation process a breeze for your crew and minimises disruptions to your business with minimal to no maintenance requirements.

Areas for Application

- Industrial Workshops
 - Public Spaces
 - Retails Stores
 - Warehouses
 - Sports Halls
 - Indoor Courts
- Manufacturing Facilities



8/94 Forsyth Street O'Connor WA, 6163

+61 (08) 6371 1780

sales@ledtec.com.au

www.ledtec.com.au

TECHNICAL SPECIFICATIONS

Product	
Model	<i>LCF 300W</i>

Luminaire Information	
Rated Power	<i>300W</i>
Operating Temperature Range	<i>-40° ~ +50° c</i>
Luminous Flux	<i>39,000lm</i>
Fixture Installation	<i>Chain Mount Hook Mount</i>
Mounted Height	<i>0-30m</i>

Electrical Characteristics	
Power Factor	<i>>0.90/230 VAC</i>
Operating Voltage Range	<i>AC 90-305V</i>
Input Current/230V	<i>2.17A/230VAC</i>
Frequency Range	<i>50-60Hz</i>
Light Efficacy	<i>125-135lm/w</i>
Driver Type	<i>Mean Well</i>

Optical Characteristics	
Correlated Colour Temperature	<i>5000k Standard (Optional 2700K - 6500K)</i>
Colour Rendering Index	<i>80Ra</i>
LED Type	<i>Philips Lumileds LUXEON 3030 SMD</i>
LED Quantity	<i>399pcs</i>
LED Expected Lifespan	<i>50,000 hrs</i>
Beam Angle	<i>Type A: 60° Type B: 90°</i>

Material & Finish	
Ingress Protection Rating	<i>IP65</i>
Impact Rating	<i>IK08</i>
Material Composition (Body)	<i>Aluminium alloy</i>
Material Composition (Driver Box)	<i>Casting Aluminium</i>
Material Composition (Lens)	<i>Stalinite Glass</i>
Material Composition (Bracket)	<i>Hot Rolled Carbon Steel</i>
Material Composition (Cable)	<i>Polyvinyl chloride</i>

Weight & Packaging	
Diameter	<i>320mm</i>
Packaging Dimensions	<i>350 x 350 x 240mm</i>
Packaged Weight	<i>6.3kg</i>
Cable Length	<i>1.4m</i>

Warranty	
Warranty	<i>5 Years</i>

COLOUR TEMPERATURES

WARM WHITE
2700K - 3000K

COOL WHITE
5900K - 6500K

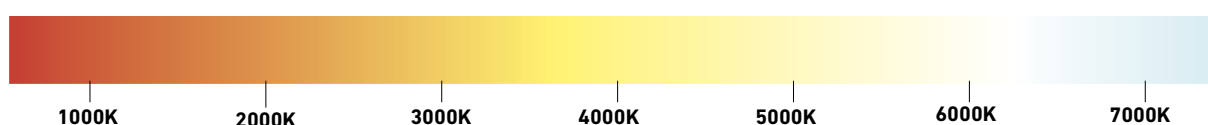

ILLUMINANCE AT DISTANCE

TYPE A: 60°

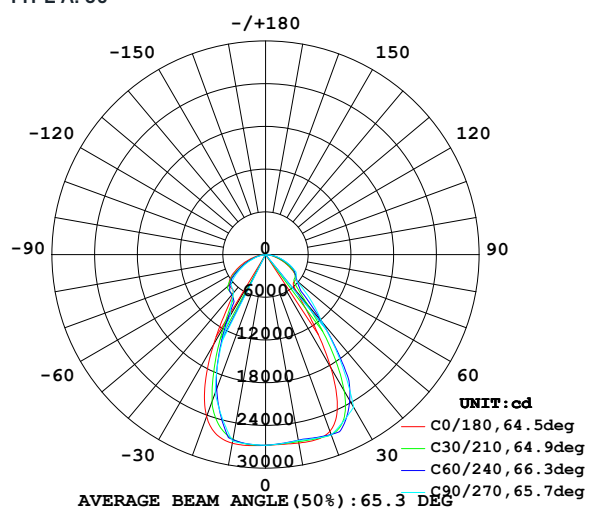

TYPE B: 90°

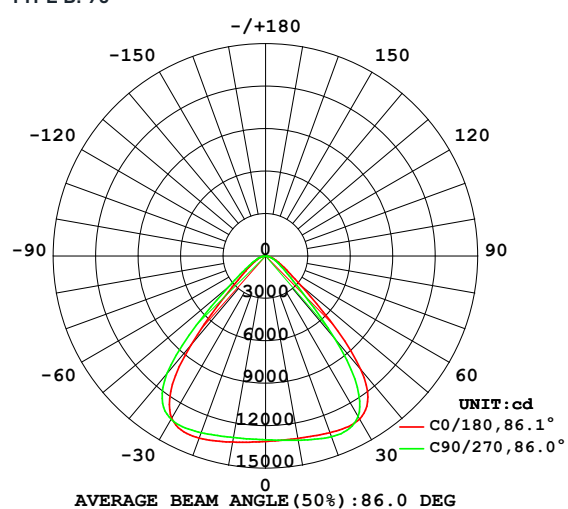

DIMENSIONS

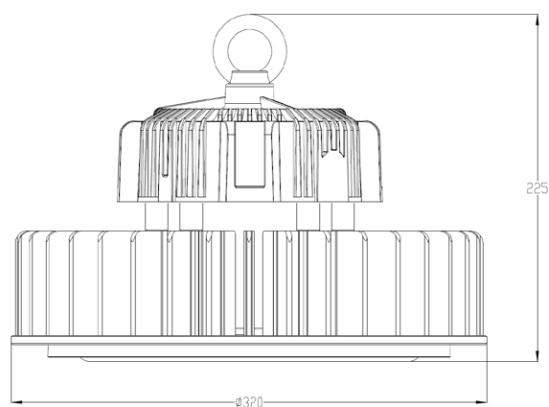

WIRING DIAGRAM

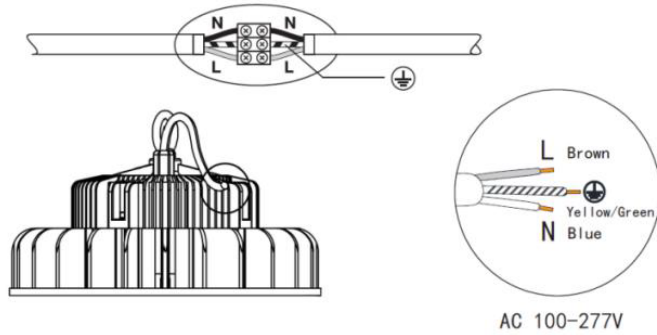

MOUNTING OPTIONS

CHAIN MOUNT

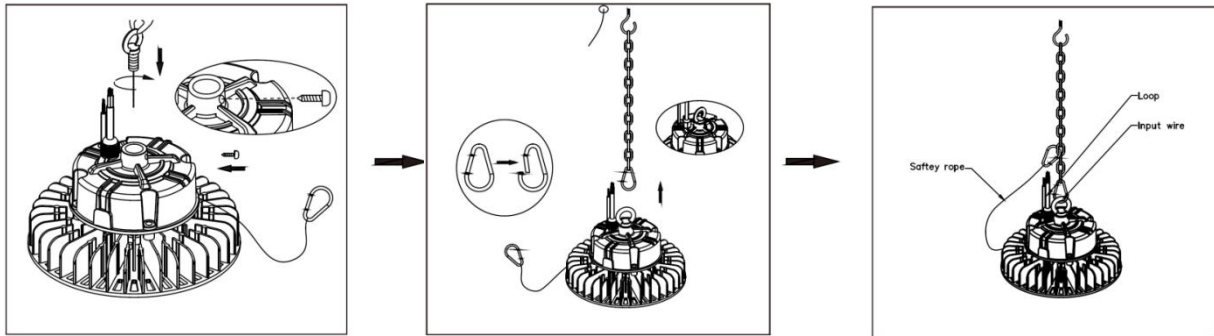

1. Unscrew the screw on top of the driver
2. Screw the circular ring tightly, then lock the circular ring using the screw
3. Fix the highbay fixture with the chain to the ceiling
4. Use the buckle to fix the safety rope with the body and chain
5. Make all wiring connections. If dimming is not required, leave the caps on dimming leads

HOOK MOUNT

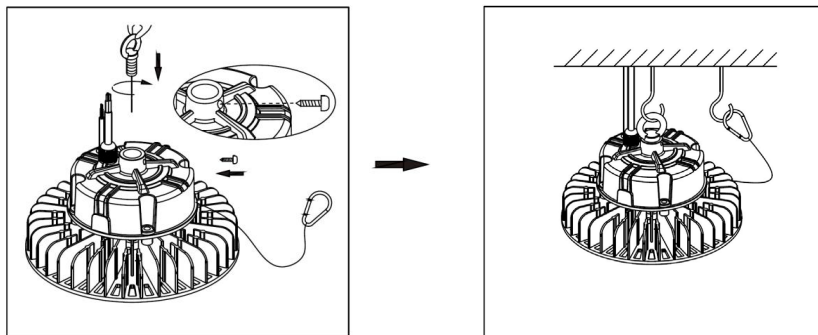

1. Unscrew the screw from the top of the driver
2. Screw the circular ring tightly, then lock with using the screw
3. Carefully hang the LCF highbay into the lifting hook, making sure the hook can carry more than 3 times the weight of the luminaire
4. Use the buckle to fix the safety rope with the body and hook
5. Make all wiring connections. If dimming is not required, leave the caps on the dimming leads

CAUTION: Ensure all power to the lights is switched off before carrying out installation.